

CONRAIL

BALTIMORE-WASHINGTON
DISTRICT

TERMINAL INFORMATION
PUBLICATION

WPBV10
6-DAY TRAVELING SHIFTER

BAY VIEW TO BOWIE, MD

CREW SYMBOL: WPBV10 SIGN UP TIME: 19:30 POOL CODE: 403

JOB PROFILE

THIS ASSIGNMENT IS A SIX (6) DAY TRAVELING ROAD SWITCHER ADVERTISED TO OPERATE FROM BAY VIEW SOUTH END TO BOWIE, MD OVER AMTRAK TERRITORY AND IS ALSO ADVERTISED TO OPERATE ON THE POPE'S CREEK SECONDARY TRACK AT BOWIE, MARYLAND. ADVERTISED REST DAY IS SATURDAY.

CUSTOMER SERVICE PROFILE

1. LIPTON

ZTS 841 D-YES - 2

THERE IS A DERAIL THAT IS CONNECTED TO THE SWITCH ON AMTRAK'S MAIN LINE AND ALSO A DERAIL LOCATED AT THE GATE. THERE IS ONE TRACK AT THIS LOCATION THAT SUPPORTS NINE (9) SPOTS. THERE IS ALSO A BUMPING BLOCK AT THE END OF THE TRACK. CREW MUST SHIFT THIS CUSTOMER FROM AMTRAK'S MAIN LINE AND COULD ENCOUNTER CONSIDERABLE DELAYS DUE TO HAVING TO CLEAR UP FOR AMTRAK TRAFFIC.

2. GRAFCO INDUSTRIES

ZTS 857 D-YES - CONNECTED TO MAIN LINE SWITCH FROM AMTRAK MAIN LINE. CUSTOMER IS LOCATED IN THE BALTIMORE COMMON'S INDUSTRIAL PARK.

3. MARYLAND NEWS DISTRIBUTORS

ZTS 843 D-YES - CONNECTED TO AMTRAK MAIN LINE SWITCH.

4. INTERNATIONAL PAPER

ZTS 881 D-YES - CONNECTED TO AMTRAK MAIN LINE SWITCH. CREW MUST UNLOCK GATE TO SERVICE THIS CUSTOMER.

5. ATLAS CONTAINER

ZTS 874 D-YES - CONNECTED TO AMTRAK MAIN LINE SWITCH. CREW MUST UNLOCK AND LOCK GATE WHEN SHIFTING THIS CUSTOMER.

HALETHORPE MD

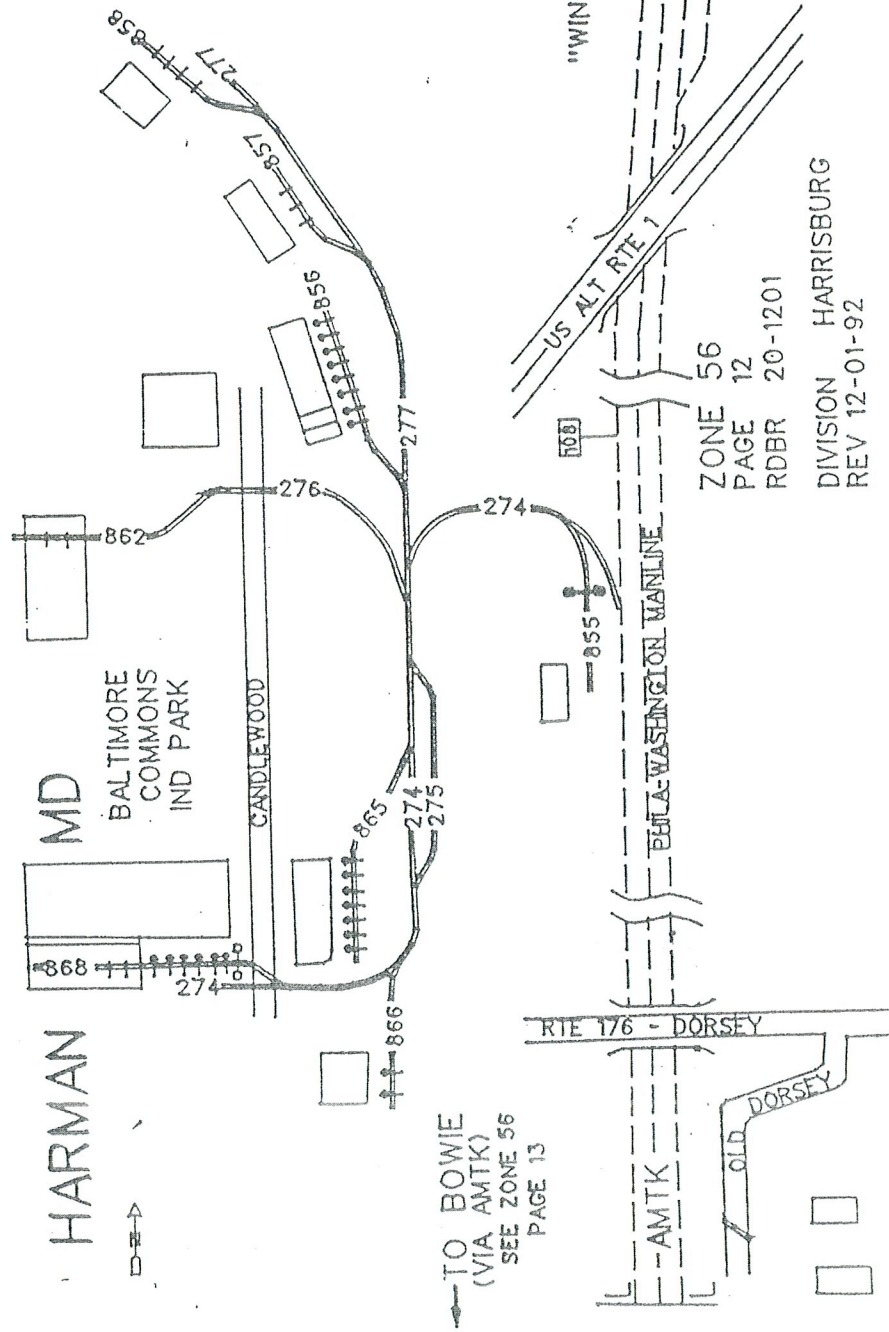

TO BALTIMORE
(VIA AMTK)
SEE ZONE 56
PAGE 11

TO BOWIE
(VIA AMTK)
SEE ZONE 56
PAGE 13

ZONE 56
PAGE 12
RDBR 20-1201
DIVISION HARRISBURG
REV 12-01-92

ODENTON MD



STATION



AMTK



ROUTE 170

ROUTE 175

279

TO BOWIE
(VIA AMTK)
SEE ZONE 56
PAGE 14

"GROVE"

PHIL-WASHINGTON MAINLINE

113

112

875

874

TO BALTIMORE
(VIA AMTK)
SEE ZONE 56
PAGE 12

ZONE 56
PAGE 13
RDBR 20-1201

DIVISION HARRISBURG
REV 12-01-92

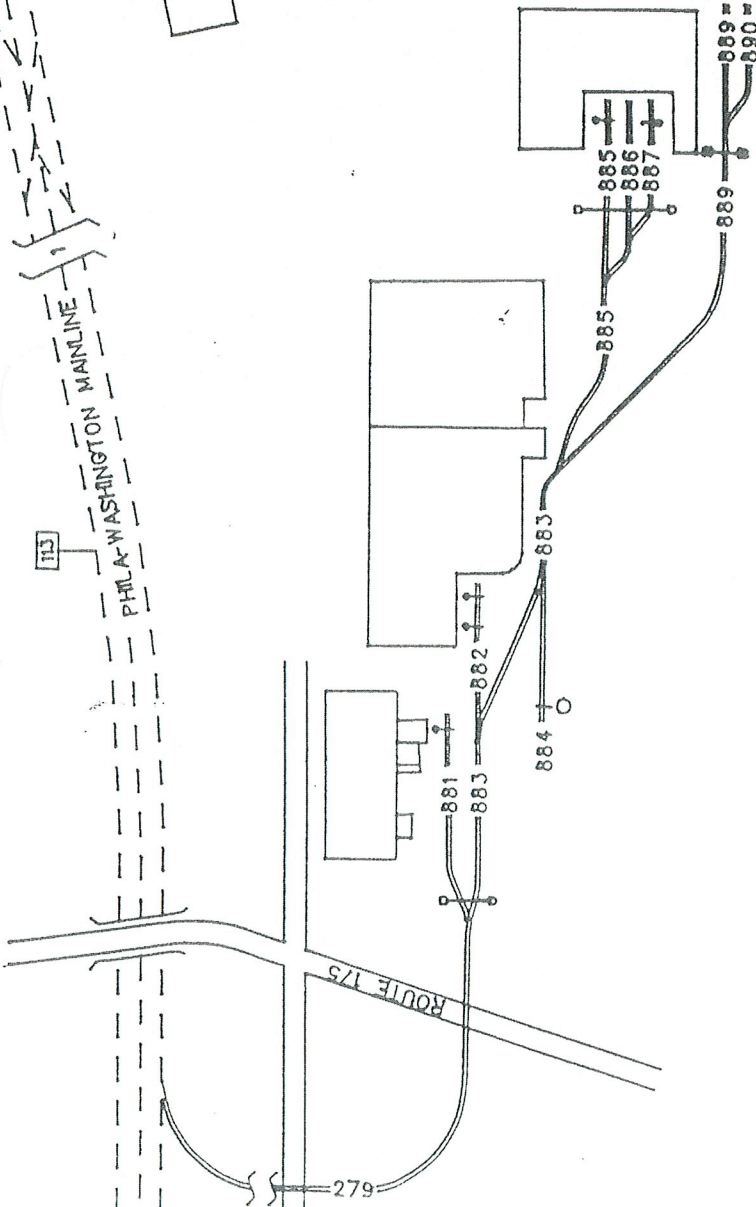

ODENTON MD

BOWIE MD

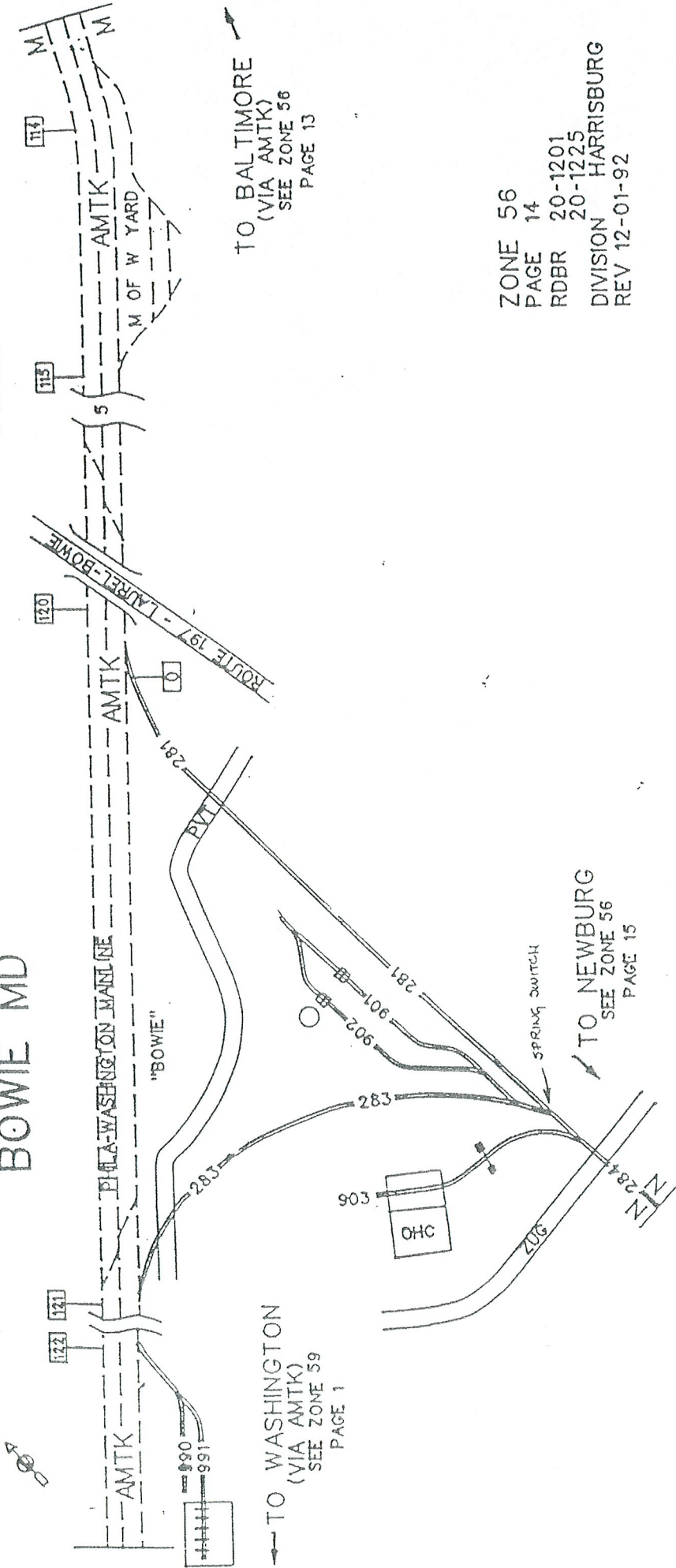

TO BALTIMORE
(VIA AMTK)
SEE ZONE 56
PAGE 13

ZONE 56
PAGE 14
RDBR 20-1201
20-1225
DIVISION HARRISBURG
REV 12-01-92

TO NEWBURG
SEE ZONE 56
PAGE 15

TO WASHINGTON
(VIA AMTK)
SEE ZONE 59
PAGE 1